

Hillerød Varme A/S - Drafting of project proposals for Gørløsegård and the Møllebro neighbourhood

Regulatory projects are drawn up to obtain approval for supplying district heating to residential areas near Gørløsegård and in Møllebro.

The project proposals were drawn up because Hillerød Municipality and Hillerød Varme A/S wanted to examine the possibilities of supplying district heating to the area sited for the construction of new low-energy houses, densely-situated low houses, residential properties and small commercial properties, all built within the framework of 2020 building projects.

The results were that a positive societal, commercial and user economy could be achieved by implementing the proposed building project, compared to the reference scenario which was heat pumps. The project proposal was adopted in the autumn of 2015 without objection.

The tasks of Damgaard Consulting Engineers include the drawing up of a complete project proposal, as well as carrying out calculations and sensitivity analyses.

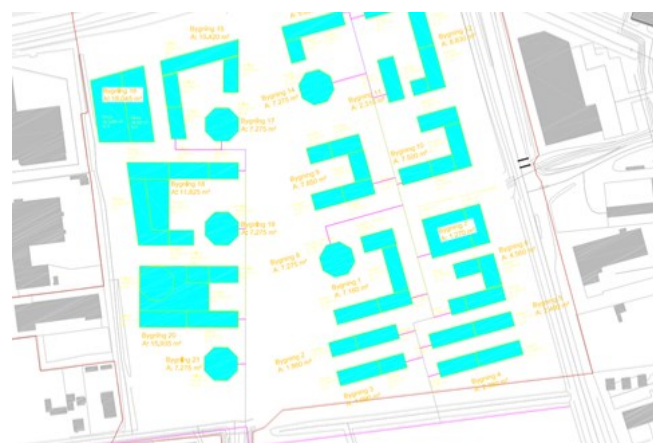

Execution: 2015

Client: Hillerød Varme A/S, Kjeld Oksbjerg